

(Annexure 2)

CERTIFICATE OF LAND

File No

Date 23-1-19

Certified that land measuring 13152.28 (3.2 Acre) situated in Khasra No. (s) 52//16/1/2 (*2-1), Khasra No. (s) 52//17 (8-0), Khasra No. (s) 18/2 (5-2), Khasra No. (s) 23/1/1 (2-11), Khasra No. (s) 23/1/2 (5-5), Khasra No. (s) 51//20/1/2 (1-16), Khasra No. (s) 52//16/2/ (1-17) Total land 26 Canal 12 Marle at Dabra Road, Near Royal Palm Banquet Hall, Hisar fully described in the schedule mentioned hereinafter, is owned by DAV College Managing Committee, New Delhi for I.D. DAV Public School, Hisar in terms of Sale Deed dated 02.03.2001 & 23.05.2002 executed by Tehsildar. Duly registered on 02.03.2001 & 23.05.2002 at Serial No in book no 8256, 8257, 1169 and 1170 volume no & Mutation no. 2920 in the office of Tehsil Office. It is certified that the said entire land comprises of a single plot of land.

It is further certified that I.D. DAV Public School, Hisar is located on the said plot of land.

THE SCHEDULE OF LAND ABOVE REFERRED TO

All that piece and parcel of land measuring 13152.28 Sq. meter situated in Khasra No. (s) 52//16/1/2 (*2-1), Khasra No. (s) 52//17 (8-0), Khasra No. (s) 18/2 (5-2), Khasra No. (s) 23/1/1 (2-11), Khasra No. (s) 23/1/2 (5-5), Khasra No. (s) 51//20/1/2 (1-16), Khasra No. (s) 52//16/2/ (1-17) Total land 26 Canal 12 Marle at Dabra Road, Near Royal Palm Banquet Hall, Hisar and bounded as follows:

- North Agricultural Land
- East Street
- West Agricultural Land
- South Agricultural Land

PRINCIPAL
 D.M. Institute Cr. Sec. School
 VILLAGE : MOHAMMAD NAGAR
 TILL LOHARU DISTT. DHIRWANI
 (Haryana) 127201

PRINCIPAL
 Delhi International Public
 Sr. Sec. School
 HASSANGARH (Rohtak)

DISTRICT MAGISTRATE REGISTERING AUTHORITY WITH DESIGNATION

(Name of Officer)

(Name of District) Hisar

Handwritten notes in Hindi describing land parcels and their measurements, including references to Khasra Nos. 52, 18, 23, and 51.

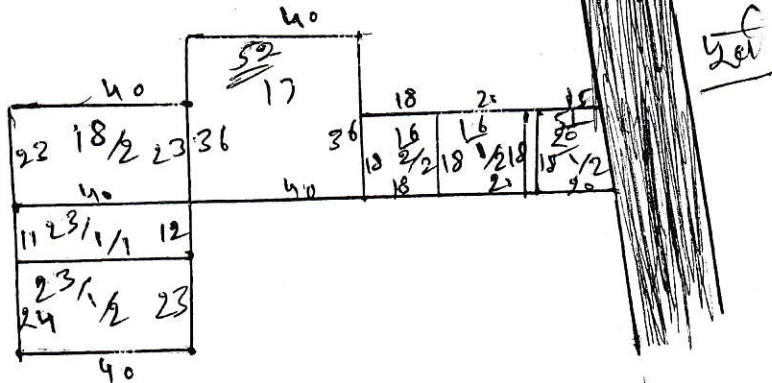

Handwritten notes in Hindi, including the name 'Principal' and 'Teacher Incharge', and a date '16-1-2019'.

Principal
 I.D. D.A.V. Public School
 HISAR
 Teacher Incharge
 I.D. DAV Public School
 HISAR

Principal
 I.D. D.A.V. Public School
 HISAR

Manager
 I.D. D.A.V. Public School
 HISAR